



Special discount, 50% off, is available for those who apply and rent a vacant room at the office on the day.

For example, when applying for and rent 3rd seminar room during AM time period(9am to 12pm) at the office on the day, the 50% off is applied to the room charge: 360yen discounted to 180yen.

TEL:072-292-0010



Sakai city Youth House

Users' Guide



Wi-Fi
Free Wi-Fi

Managed by Japan Environment Management Co., Ltd.



Youth house supports everyone's "I want to try!" in sports, music, art, leaning, and more!!

Youth house is a great place to start something new since there are a variety of rooms/facilities such as a sports field, music room, craft room, outdoor cooking area.

Also, interesting events or classes are held at Youth house.
Come to Youth house with friends, meet someone new, and find what you love!

Address	32 Katakura, Sakai-shi Minami-ku Osaka-fu, 590-0121
Contact	Phone: 072-292-0010 FAX: 072-292-3825
Email	sakai_youthhouse@nem-shiteikanri.jp

— Official Website and SNS —



Website



LINE

@314belta



X

@youthhouse_osc



Instagram

youthhouse.sakaicity



✦ Outside

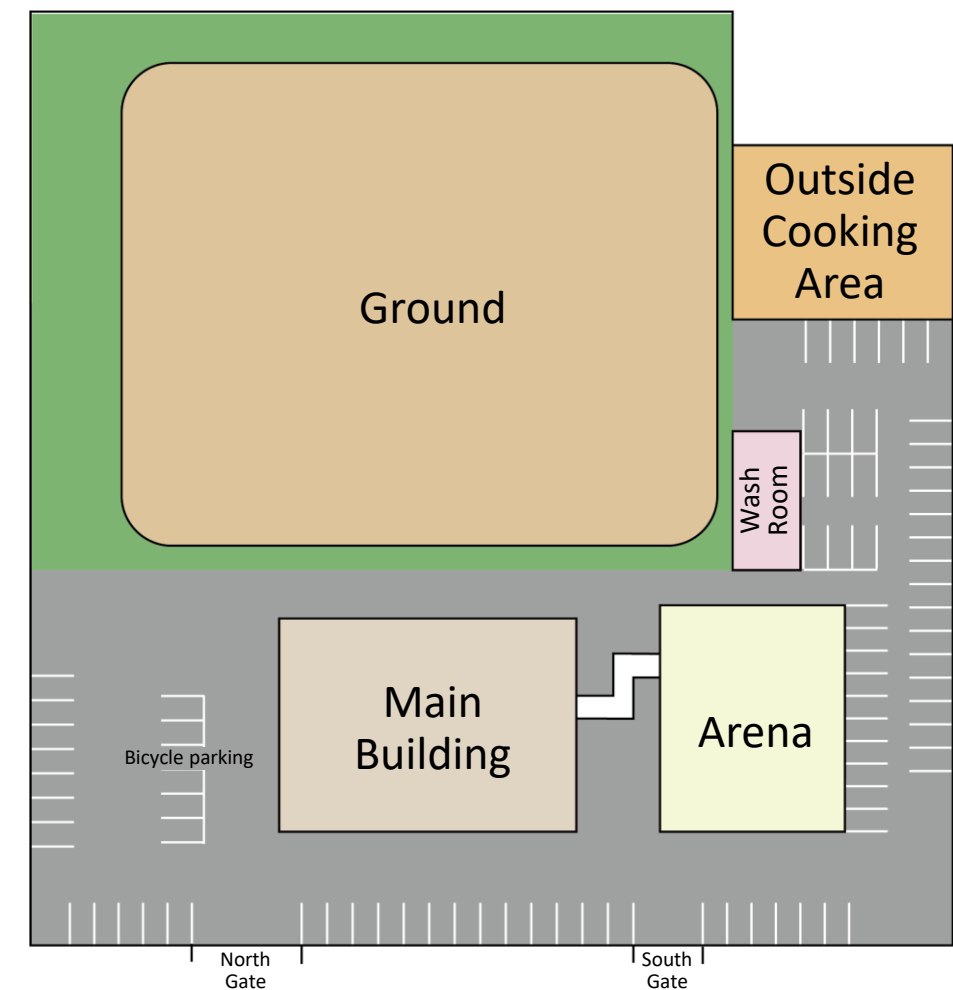

The Outdoor cooking area is free to use!
Perfect for a day-camp or barbeque on weekend!



Ground

Let's play
Baseball!!

Sports day!

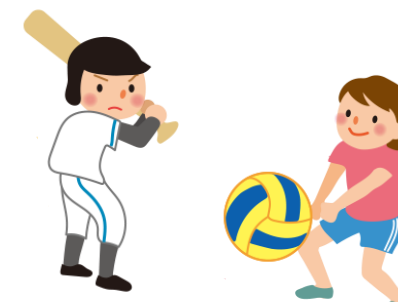

Outdoor Cooking Area

Free of charge
Rentals

Rental Equipment
(Pots, Iron plate, dishes
Camping gear)



❖ 1st Floor

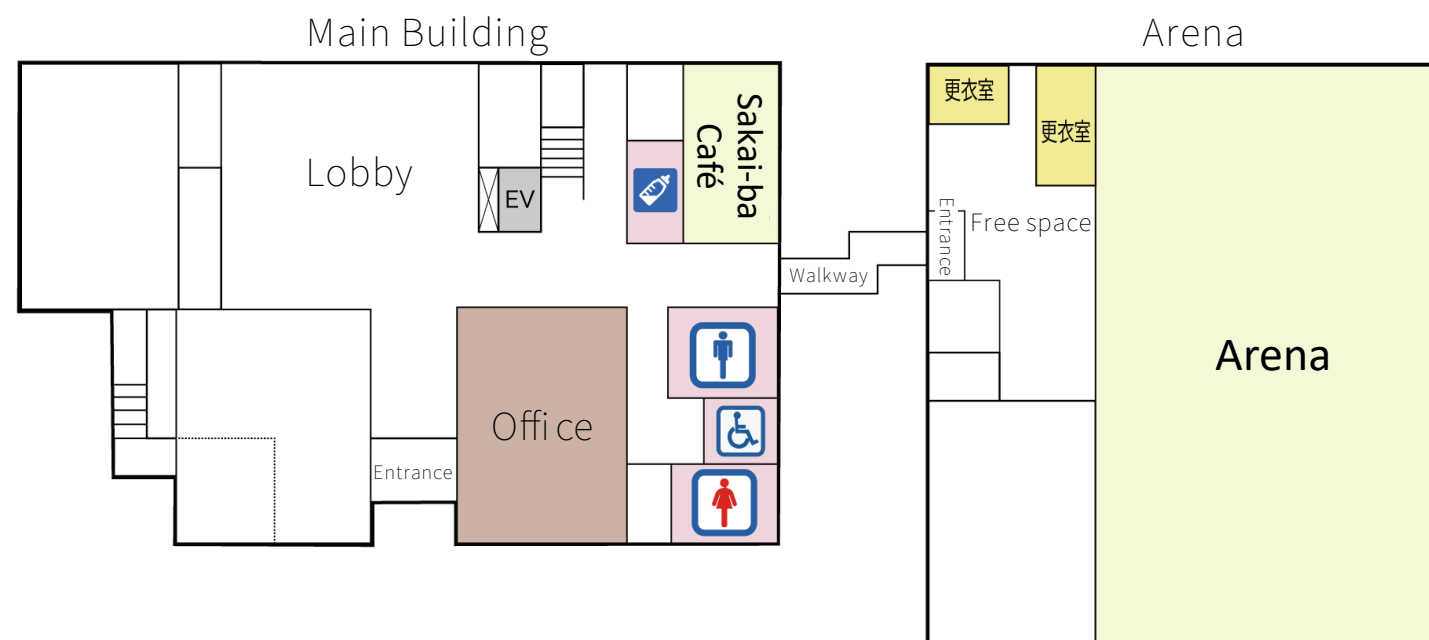

In the office, we offer rentals of Othello, Go, Shogi, UNO, playing cards, and more. Please feel free to ask us anytime!"



Arena

Equipment (No charge)
Goods for volleyball, basketball
or futsal (i.g. balls)



Lobby

**Food/Drink
allowed.**

**Vending
Machines
(Drinks/snacks)**

❖ 1st Floor

Sakai-ba Café

**No charged
Room**



Sakai-ba is a place where young people, teenagers or 20s, can spend time casually. For example, you can get together with your friends for study or chatting. You can even spend your own time here, browsing magazines, etc. Sakai-ba offers you a space to relax or enjoy different atmosphere from home or school, will be your third place!!

Please stop by anytime!

<Hours> 9:00am~8:45pm
Elementary school students 9:00am~5:30pm
Junior high school students 9:00am~8:00pm
<Capacity> 16 people



❖ 2nd Floor

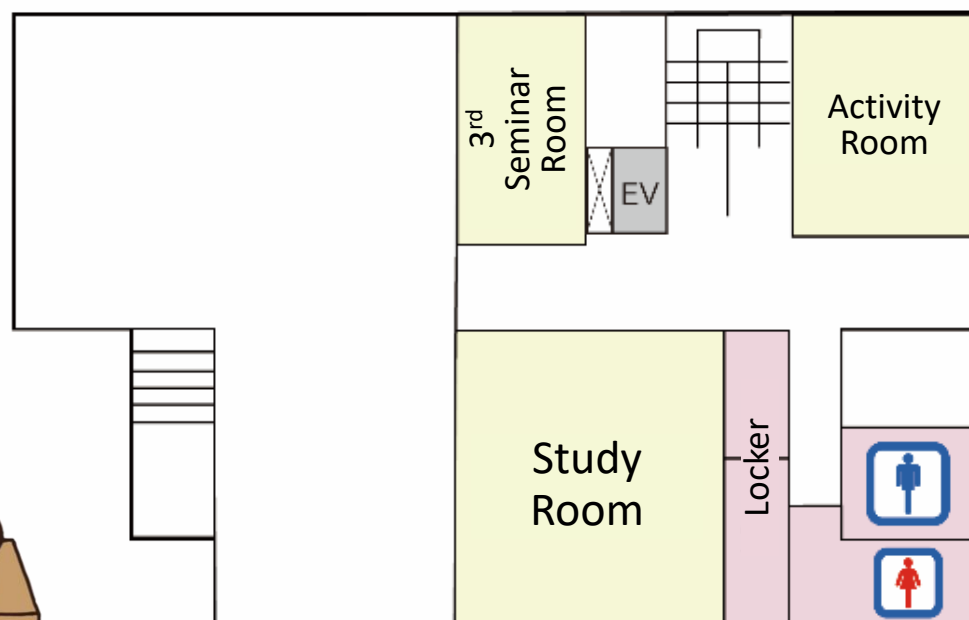

Quiet environment, suited for study or meetings.



3rd Seminar Room

For Small Groups

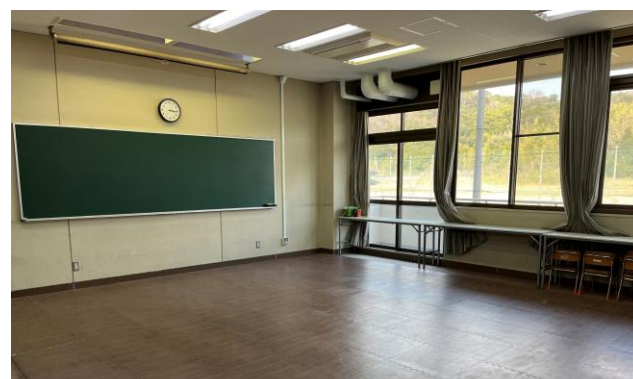

Activity Room

Cushioned Floor



Study Room

Free of Charge

9:00am to 8:45pm

❖ 3rd Floor

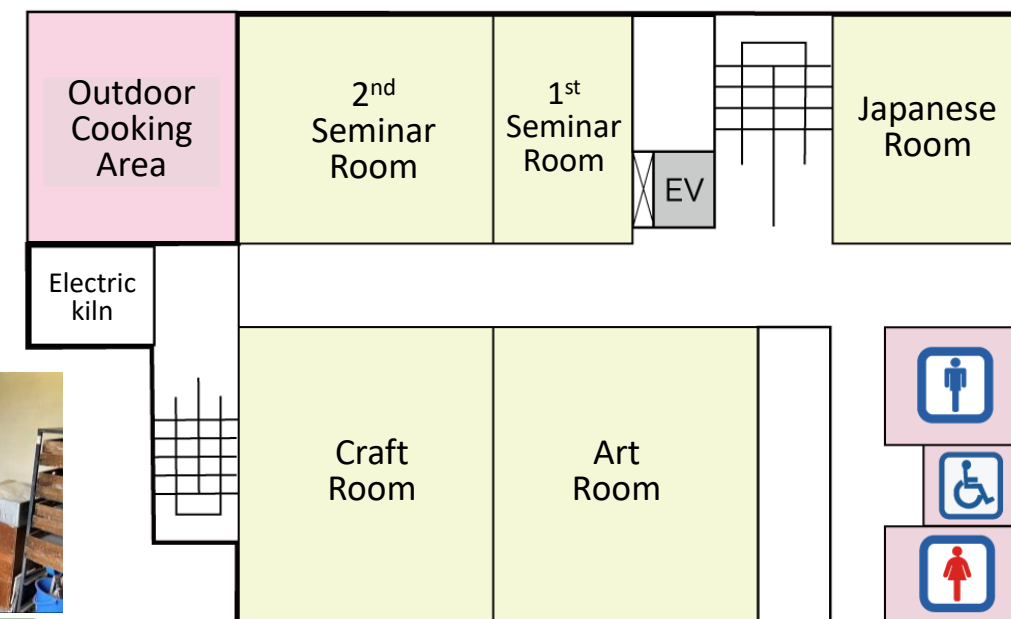

Electric kiln for pottery

Painting, pottery, or craft-making, etc...

Let's gather with friends and make something unique!



1st Seminar Room

Food/Drink Allowed

For Small Group

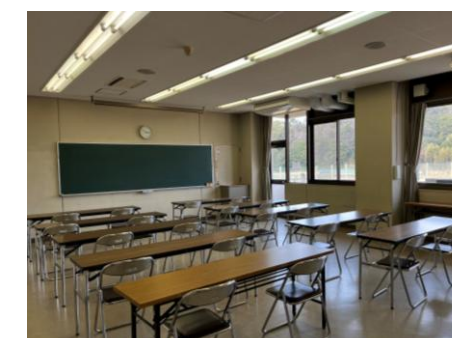

2nd Seminar Room

Food/Drink Allowed

For Large Group



Japanese Room

Available besides Sa-do or Ka-do



Art Room

Food/Drink Allowed

Available besides Art purpose



Craft Room

Food/Drink Allowed

Equipment
Pottery wheels: No charge
Electric kiln for pottery: Charged

4th Floor

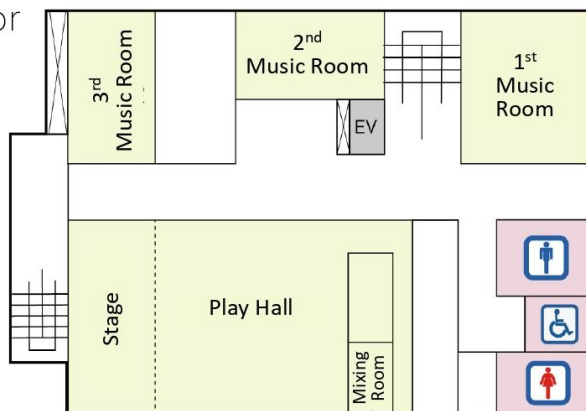

Drum set is available at free of charge.
Perfect place for karaoke or band practice
due to sound-proofed rooms!



1st Music Room

Equipment
Drum Set: No charge
Grand Piano: charged



2nd Music Room

Equipment
Drum Set: No charge
Electronic Organ: No charge



3rd Music Room

Equipment
Drum Set: No charge
Upright Piano: No charge



Play Hall

Equipment
Grand Piano: Charged

Stage is available.
Perfect for a playing or
music recital.

Price List

Room/Capacity(ppl)/Class			Morning	Daytime	Evening	Morning - Daytime	Daytime - Evening	1 day
			9am - 12pm	1pm - 5pm	6pm - 9pm	9am - 5pm	1pm - 9pm	9am - 9pm
Play hall	150	Adult	4,580JPY	6,120JPY	5,400JPY	10,700JPY	11,520JPY	16,100JPY
		Youth	2,290JPY	3,060JPY	2,700JPY	5,350JPY	5,760JPY	8,050JPY
Activity Room	30	Adult	920JPY	1,320JPY	1,020JPY	2,240JPY	2,340JPY	3,260JPY
		Youth	460JPY	660JPY	510JPY	1,120JPY	1,170JPY	1,630JPY
1 st Seminar Room	20	Adult	720JPY	820JPY	820JPY	1,540JPY	1,640JPY	2,360JPY
		Youth	360JPY	410JPY	410JPY	770JPY	820JPY	1,180JPY
2 nd Seminar Room	42	Adult	1,320JPY	1,520JPY	1,420JPY	2,840JPY	2,940JPY	4,260JPY
		Youth	660JPY	760JPY	710JPY	1,420JPY	1,470JPY	2,130JPY
3 rd Seminar Room	20	Adult	720JPY	820JPY	820JPY	1,540JPY	1,640JPY	2,360JPY
		Youth	360JPY	410JPY	410JPY	770JPY	820JPY	1,180JPY
Craft Room	43	Adult	1,840JPY	2,440JPY	2,240JPY	4,280JPY	4,680JPY	6,520JPY
		Youth	920JPY	1,220JPY	1,120JPY	2,140JPY	2,340JPY	3,260JPY
Art Room	48	Adult	1,840JPY	2,440JPY	2,240JPY	4,280JPY	4,680JPY	6,520JPY
		Youth	920JPY	1,220JPY	1,120JPY	2,140JPY	2,340JPY	3,260JPY
Japanese Room	30	Adult	1,020JPY	1,420JPY	1,320JPY	2,440JPY	2,740JPY	3,760JPY
		Youth	510JPY	710JPY	660JPY	1,220JPY	1,370JPY	1,880JPY
1 st Music Room	30	Adult	1,020JPY	1,420JPY	1,320JPY	2,440JPY	2,740JPY	3,760JPY
		Youth	510JPY	710JPY	660JPY	1,220JPY	1,370JPY	1,880JPY
2 nd Music Room	20	Adult	820JPY	1,020JPY	920JPY	1,840JPY	1,940JPY	2,760JPY
		Youth	410JPY	510JPY	460JPY	920JPY	970JPY	1,380JPY
3 rd Music Room	20	Adult	820JPY	1,020JPY	920JPY	1,840JPY	1,940JPY	2,760JPY
		Youth	410JPY	510JPY	460JPY	920JPY	970JPY	1,380JPY
Arena (All)		Adult	5,680JPY	7,680JPY	4,480JPY	13,360JPY	12,160JPY	17,840JPY
		Youth	2,840JPY	3,840JPY	2,240JPY	6,680JPY	6,080JPY	8,920JPY
Arena (Half)		Adult	2,840JPY	3,840JPY	2,240JPY	6,680JPY	6,080JPY	8,920JPY
		Youth	1,420JPY	1,920JPY	1,120JPY	3,340JPY	3,040JPY	4,460JPY
Ground		Adult	2,060JPY/2h (9am - 11am, 11am - 1pm, 1pm - 3pm, 3pm - 5pm)					
		Youth	1,030JPY/2h (9am - 11am, 11am - 1pm, 1pm - 3pm, 3pm - 5pm)					
Outdoor Cooking Area		Adult	No charge (9am - 5pm)					
		Youth						

※50% of the listed fees above is additionally charged to the listed fees for Non-citizen (a company or a group is NOT located in Sakai city) use.

※100% of the listed fees above is additionally charged to the listed fees when users hold an event or a class which requires the entrance fees or any kinds of fees.

[DEFINITION of YOUTH]

(1) 25 years old or younger (2) More than a half of the Members are 25 years old or younger. (Age is applicable at the point of using the facility.)

Equipment

Grand Piano (Play hall • 1 st Music Room)		
Adult		1,840JPY
Youth		920JPY
Upright Piano (3 rd Music Room)		
Adult		1,220JPY
Youth		610JPY

Electric kiln for pottery		
Glost Firing (1 time)	Adult	3,260JPY
	Youth	1,630JPY
Bisque Firing (1 time)	Adult	2,540JPY
	Youth	1,270JPY

Equipment Set		
Full Audio System	Adult	1,840JPY
	Youth	920JPY
Full Lighting System	Adult	2,440JPY
	Youth	1,220JPY

※This is available only for those which are made or created in Craft room.

※*1 time* is per firing session, from the start of firing to the removal of items, with a maximum duration of five days.

※Turning fee is required if needed.

※This fee is applied to per time slot:
Morning, Daytime or Evening.

Rules and Regulations

❖ How to apply for use

Hour	9am to 9pm
Closed Day	<ul style="list-style-type: none"> • 2nd & 4th Monday of each month (If Monday falls on a national holiday, the facility will be closed on the following non-holiday weekday.) • New Year holidays (December 29 – January 3)

【General use (Adult)】

The application can be made from the 1st day of the month prior to the month of planned use.

【Registered Youth Group】

The application can be made from the 1st day of the 2 months prior to the month of planned use.

<Definition of Registered Youth Group>

The registered Youth Group can book rooms prior to 2 month. Also, room fees become 50% off from the listed price. (Registration is at free of charge.)

For registration, please confirm that you meet the requirements below and apply at the reception of the Youth House. Please note that the application is subject to review and may take time to be approved.

<Requirement>

- The group must aim to promote healthy friendship among youth.
- The group must have a rules of association that specifies administration and management.
- At least one of the following must apply to the group member: Reside, attend school, or work in Sakai City.
- The group must have 10 members or more.
- More than half of the members must be between primary school age until 25 years old.
- The group must be willing to actively participate in or cooperate with projects organized by Sakai City.
- The group must not be limited to a specific occupation or school.

<How to Apply>

Drop by reception at Youth house, or make reservation online.

(The reservation cannot be made via phone, but you may check availability on call.)

To make a reservation online, please access the Sakai City Public Facility Reservation System. Click on “Youth Facilities” (青少年施設), and select “Youth House” (青少年の家) to proceed with your reservation.

Sakai City Public Facility Reservation System <https://www3.11489.jp/sakai/user/Home>



<Others>

Continuous use beyond 3 days is, in principle, not permitted. Please make reservation in a way that avoids cancellations or changes. Please make sure to inform us in case of the cancellations. Fees that have already been paid are, as a general rule, non-refundable. If you apply for a change at least seven days before the date of use, you may make one modification. If a cancellation request is submitted at least seven days prior to the scheduled date of use and the reason is deemed appropriate, a refund equivalent to half of the usage fee will be granted. If a room change results in a higher fee, the price difference will be charged. However, in cases where the fee is reduced, a refund will not be provided.

For cancellations or changes, the receipt provided at the time of application is required.

<Music Room Use>

Each music room is equipped with a drum set and a mixer (Free of charge). Please inform us in advance if you desire to use them. Please note that a mixer is available for keyboard and vocals only; cannot be used to guitar or bass.

<Precaution>

Smoking is prohibited on the premises of Youth House. Eating is prohibited in Study room, Activity room, 3rd Study room, 1st Music room, 2nd Music room, and 3rd Music room.

Please refrain from shouting, causing noise, engaging in violence or any behavior that may disturb others.

Please take all the garbage with you when you leave.

Access

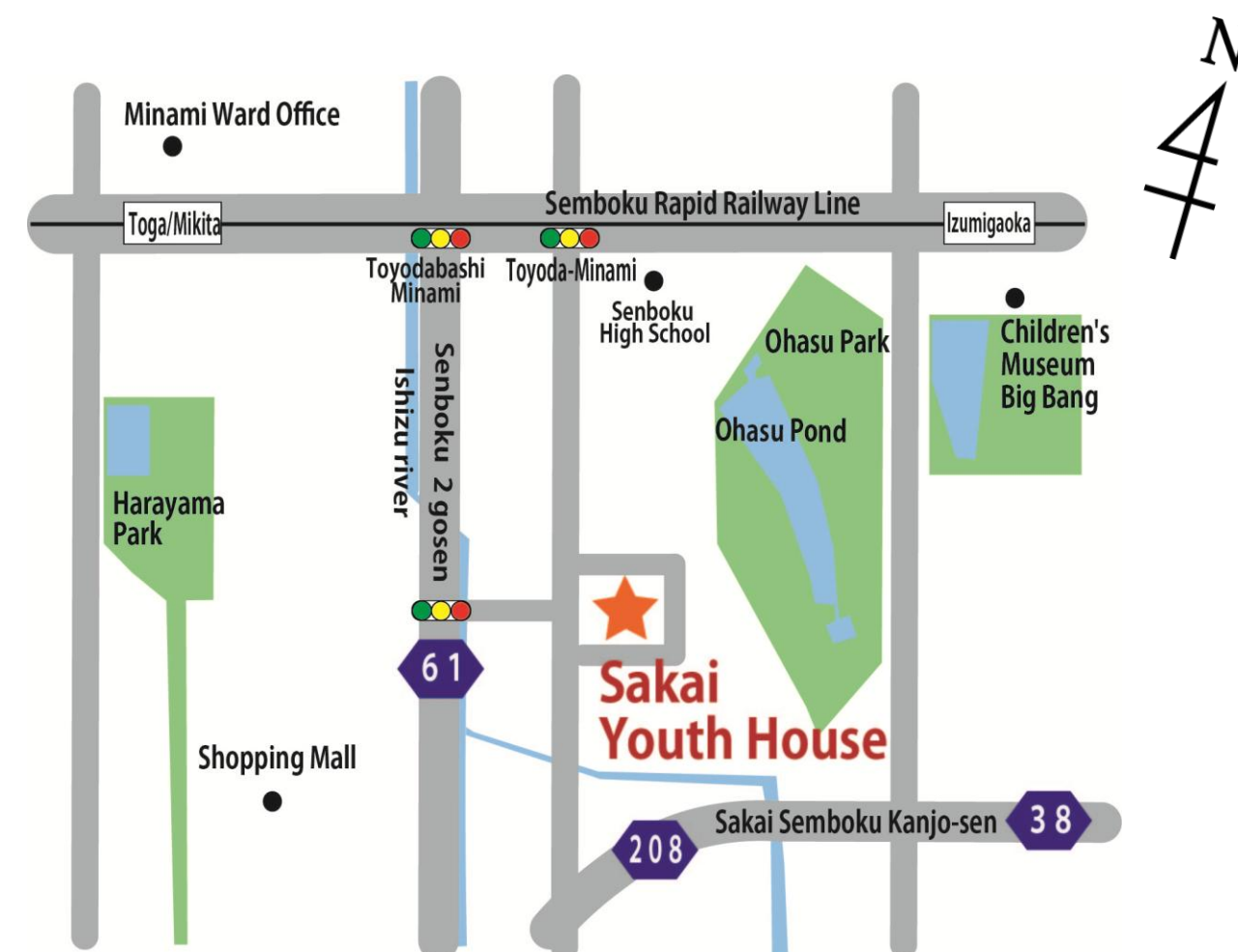

❖ By Public Bus

Take a Nankai bus at #2 bus platform (To Hachigamine/Hata) in Izumigaoka Station (South side), and Get off at Katakura bus stop (about 10min ride).

❖ By Car

- Go SOUTH approximate 600 meter from Toyoda Minami intersection on Senboku 1st line, the facility is located on LEFT side.
- Go NORTH approximate 800 meter from North intersection of Izumida Junior high, the facility is located on RIGHT side.

●On-site Parking • • • 89cars (including spaces exclusively for kei cars and compact vehicles)

●Priority Parking • • • 2cars

<Open hour> 9am to 9pm

<Fees> Free of charge